

Grossmont Healthcare District



December 2017 Prop G Board Report

Reflection

A close-up photograph of a red Christmas ornament hanging from a pine branch. The ornament is a smooth, glossy red sphere with a silver-colored metal cap and a ring at the top. The background is filled with warm, golden-yellow bokeh lights and several gold star-shaped decorations hanging from thin wires. The overall atmosphere is festive and cozy.

“Blessed is the season which
engages the whole world in a
conspiracy of love.”

H. W. Mabie

Overview

1. Regulatory Compliance
2. H&V Level 1 Surgery Build Out
3. The plans:
 - i. Sharp Infill/Build Out
 - ii. Surgery Suite Overview
4. Schedule
5. Budget
6. Snapshot on Sharp HealthCare Infill Project
7. Looking Ahead



#1029, #1030:
Wall protection complete; finish
floor installation in progress

1. Regulatory Compliance

December 2017



Project	Safety Event	Infection Control Breach	Notice of Non-Compliance
Level 1 Surgery Build Out	0	0	0 

West Corridor #1003: Swinerton Superintendents Greg & Scott inspecting their handiwork & looking for a pathway for yet one more item!

2. H&V Level 1 Surgery Build Out

December 2017

- Schedule delays: 65 days approved to date. 9 additional days of delay are reflected in the current schedule.
- Mechanical, electrical finishes being installed in ORs #1025, #1027
- Finish flooring underway in ORs #1029, #1030, and all support spaces, South half of floor
- Cath Labs #1032, #1033 painted, ready for wall protection; Cath Labs #1023, #1024 ready for paint; all core spaces painted
- East, South Corridors ready for paint



**Happy Holidays from the Team:
Kate. Vicki. Mary**

3i. Sharp Infill/GHD Build Out Plans

December 2017

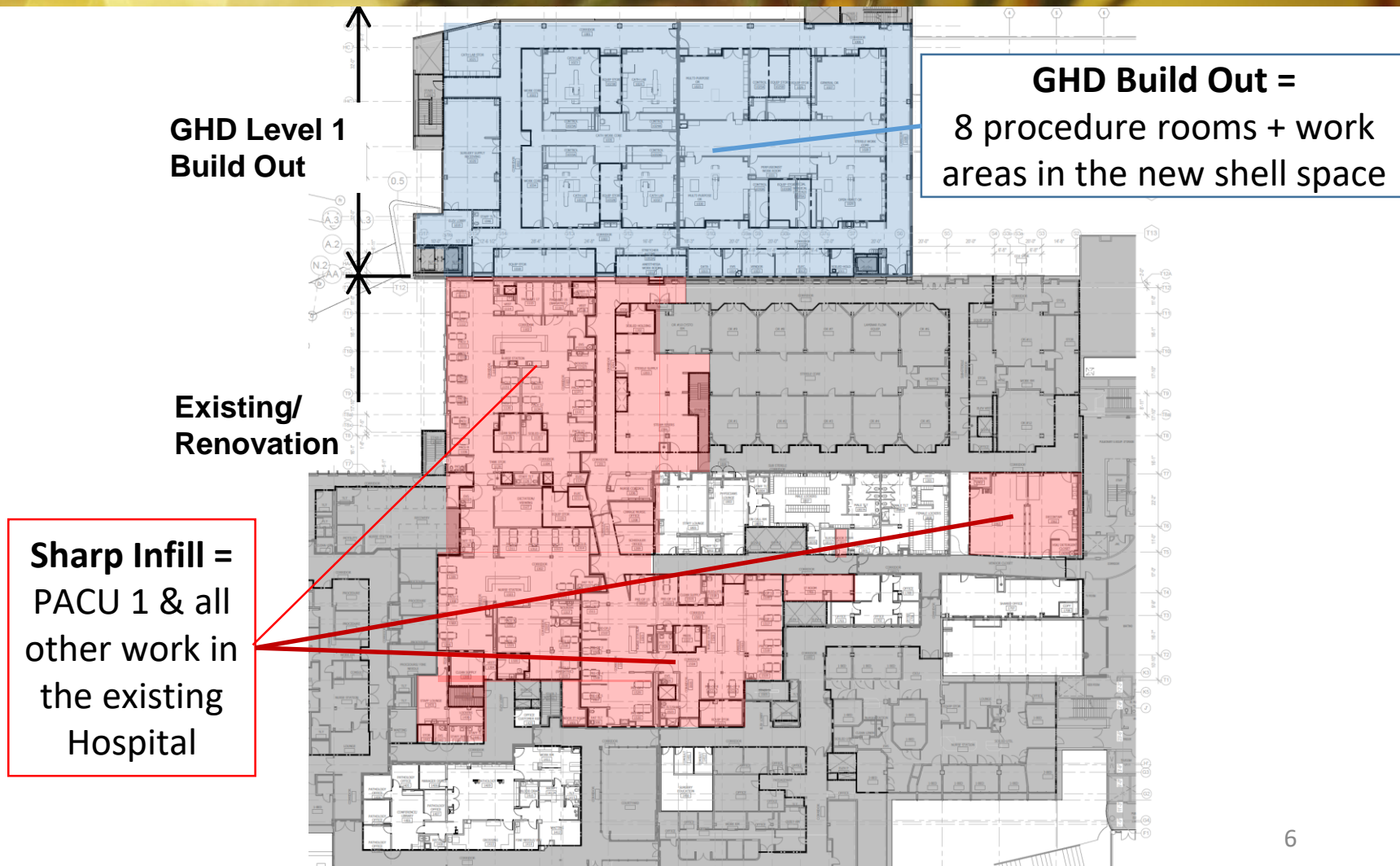

3ii. Surgery Suite Overview Plan

December 2017

The Project

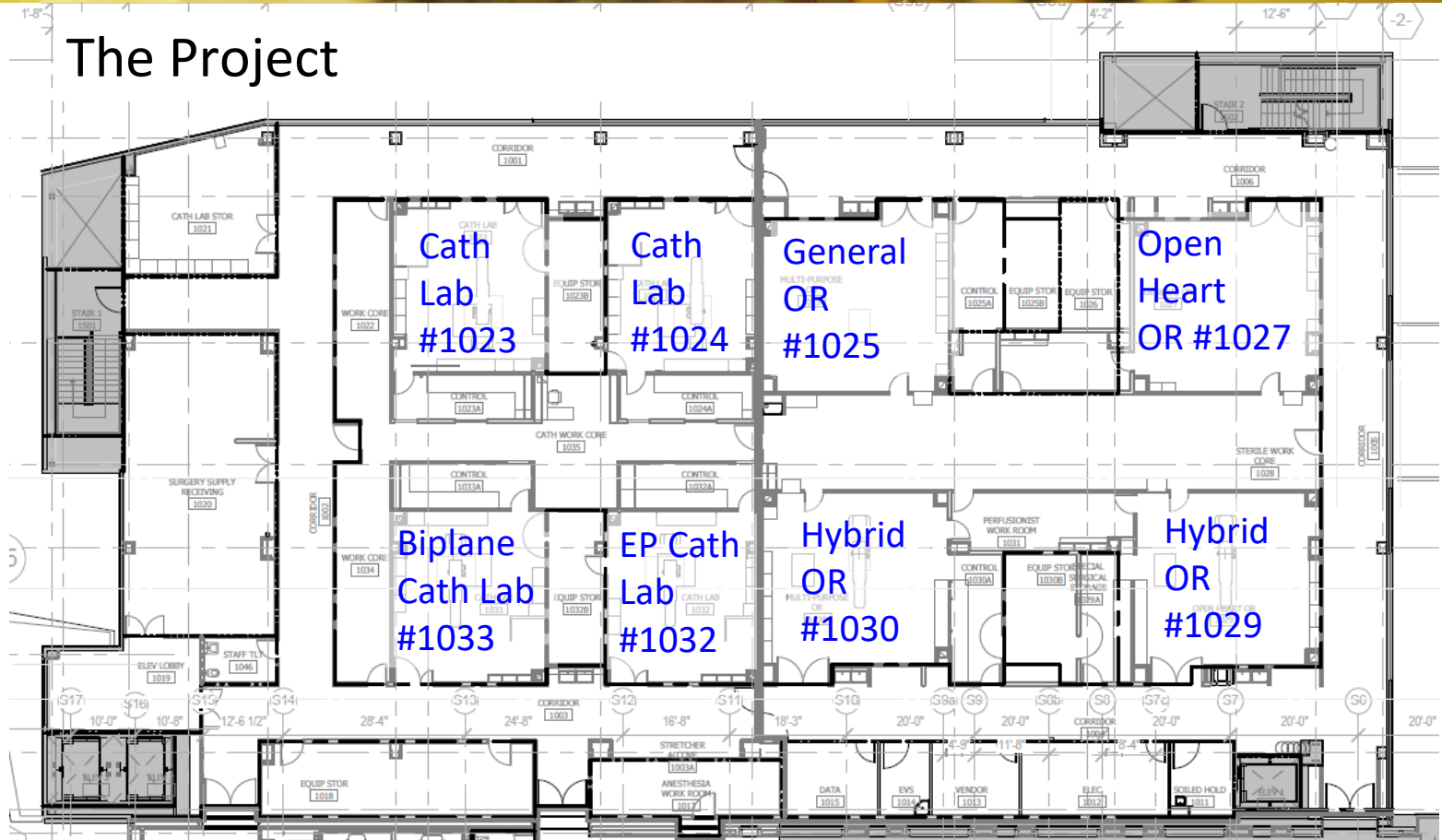

5. Budget

December 2017



Category	Project Name	Projected Cost At Completion (12/20/17)	Projected Cost At Completion (11/27/17)
Funds Available	Total Prop G Building Fund (Bond Proceeds, Interest Earned, Grants, Etc.)	\$257,072,011	\$257,072,011
Projects Completed	Central Energy Plant, ED-CCU, Heart & Vascular Bldg, East Tower Renovation, Early Utilities	\$225,996,922	\$225,996,922
	Remaining Prop G Building Funds before Level 1 Surgery	\$31,075,089	\$31,075,089
Projects Under Construction	H&V Level 1 Surgery Floor Buildout	\$29,533,684	\$29,533,684
	Potential Surplus	\$1,541,405	\$1,541,405

6. Snapshot on Sharp HealthCare Infill Project

December 2017

- Ongoing Level 1 PACU 1 construction work to install overhead/in-wall utilities & drywall
- Complete Level 1 PACU 2 deck reconstruction
- Level 1 ongoing expansion joint installation of existing utilities to meet OSHPD seismic criteria
- Start coring & new plumbing installation above ceiling in existing Level A Kitchen, Elect. rooms for new Level 1 PACU



Overhead Utilities Installation



PACU 1 Drywall Installation

7. Looking Ahead

December 2017

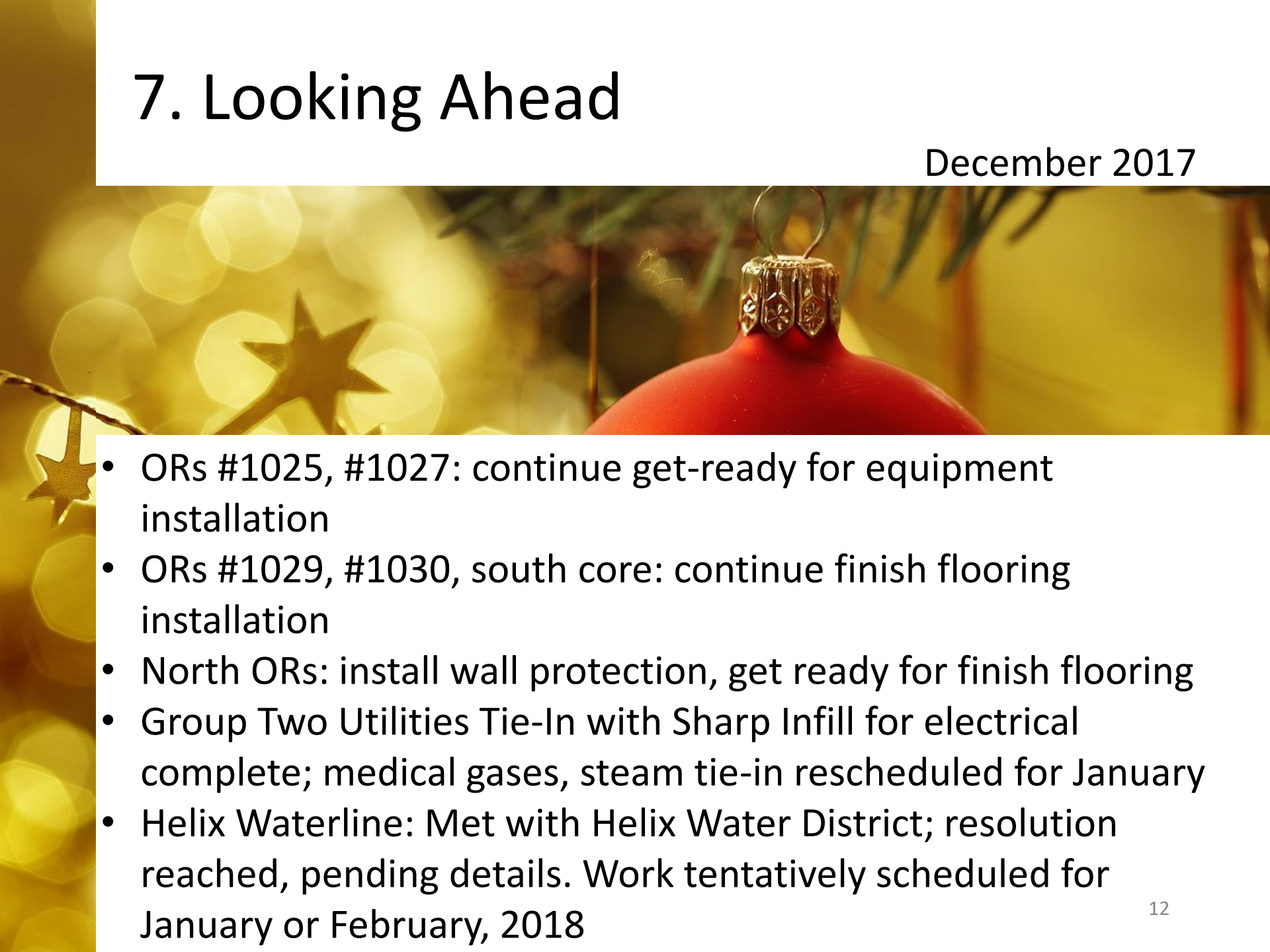
- 
- ORs #1025, #1027: continue get-ready for equipment installation
 - ORs #1029, #1030, south core: continue finish flooring installation
 - North ORs: install wall protection, get ready for finish flooring
 - Group Two Utilities Tie-In with Sharp Infill for electrical complete; medical gases, steam tie-in rescheduled for January
 - Helix Waterline: Met with Helix Water District; resolution reached, pending details. Work tentatively scheduled for January or February, 2018

An aerial photograph of a sandy beach. In the upper portion, the ocean waves are breaking, creating white foam. The sand is a light tan color. In the lower portion, the word "HOLDERS" is written in the sand in a dark, textured font, possibly made of small stones or shells. The letters are arranged in a slightly curved line.

HOLDERS

Questions?