

Grossmont Healthcare District

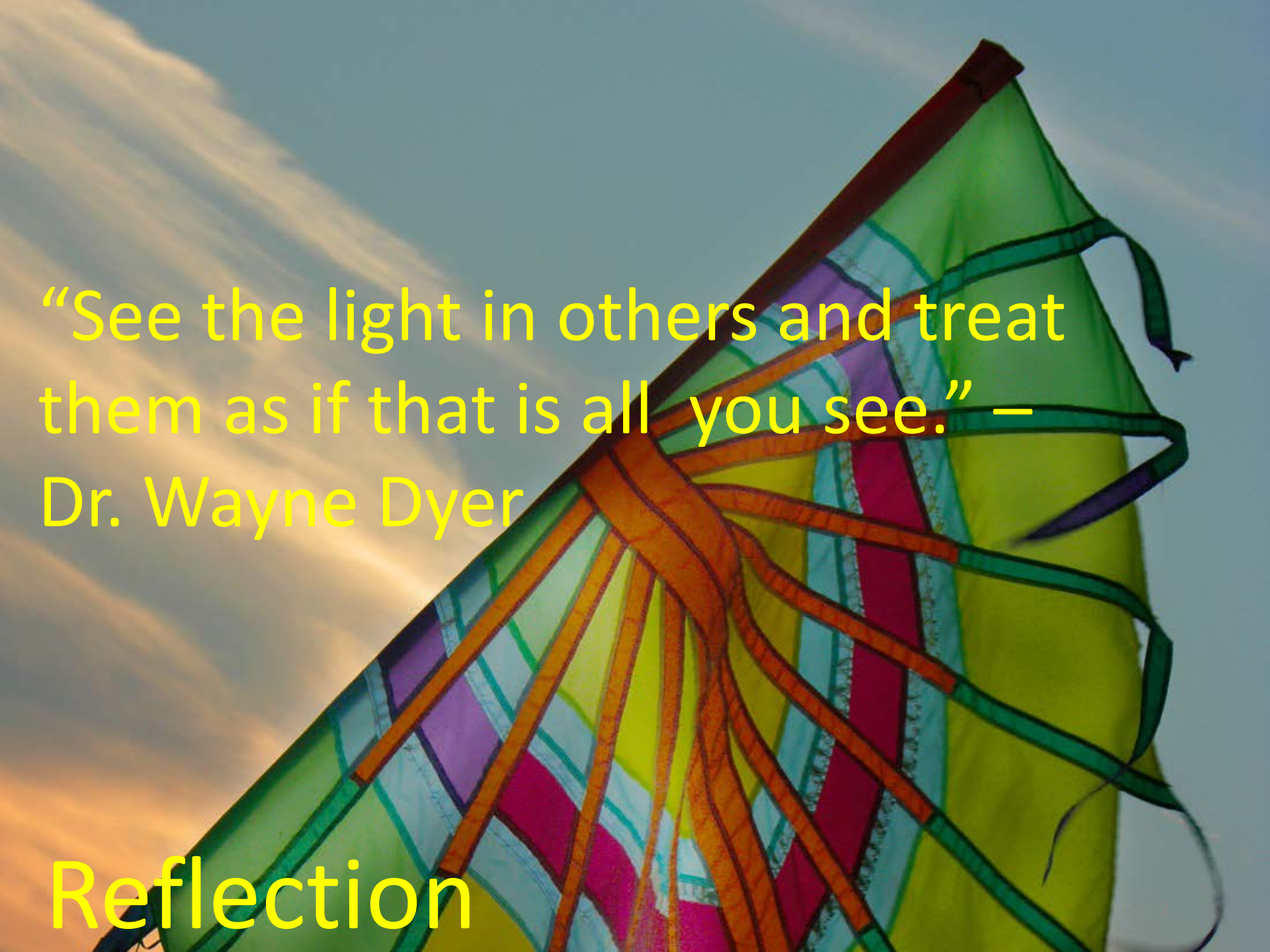

September 2017 Prop G Board Report

A vibrant, multi-colored kite is shown flying against a sky with soft, golden light from a setting or rising sun. The kite's fabric is a mix of bright green, purple, pink, and blue, with a network of orange and brown ribbons forming its structure. The sun is partially visible on the left, creating a lens flare effect across the sky.

“See the light in others and treat them as if that is all you see.” –
Dr. Wayne Dyer

Reflection

Overview

September 2017

1. Regulatory Compliance
2. H&V Level 1 Surgery Build Out
3. The plans:
 - i. Sharp Infill/Build Out
 - ii. Surgery Suite Overview
4. Schedule
5. Budget
6. Snapshot on Sharp HealthCare Infill Project
7. Looking Ahead



Medical Gas Zone Valves,
Complete

1. Regulatory Compliance

September 2017



Cath Lab #1023: Mechanical ductwork installation, structural framing to support booms and CT Scanner, med gas lines complete

Project	Safety Event	Infection Control Breach	Notice of Non-Compliance
Level 1 Surgery Build Out	0	0	0 

2. H&V Level 1 Surgery Build Out

September 2017

- Schedule delays holding at 50 days plus Owner 20 day float included in contract
- Drywall complete in all ORs, nearing completion in all other areas
- Ceiling framing underway in ORs #1025 & #1027
- P-Tube station roughed-in, piping installed in sterile core
- All Air Handling Equipment in place on the roof



Control Rooms: Overhead Electrical
Nearing Completion

3i. Sharp Infill/GHD Build Out Plans

September 2017

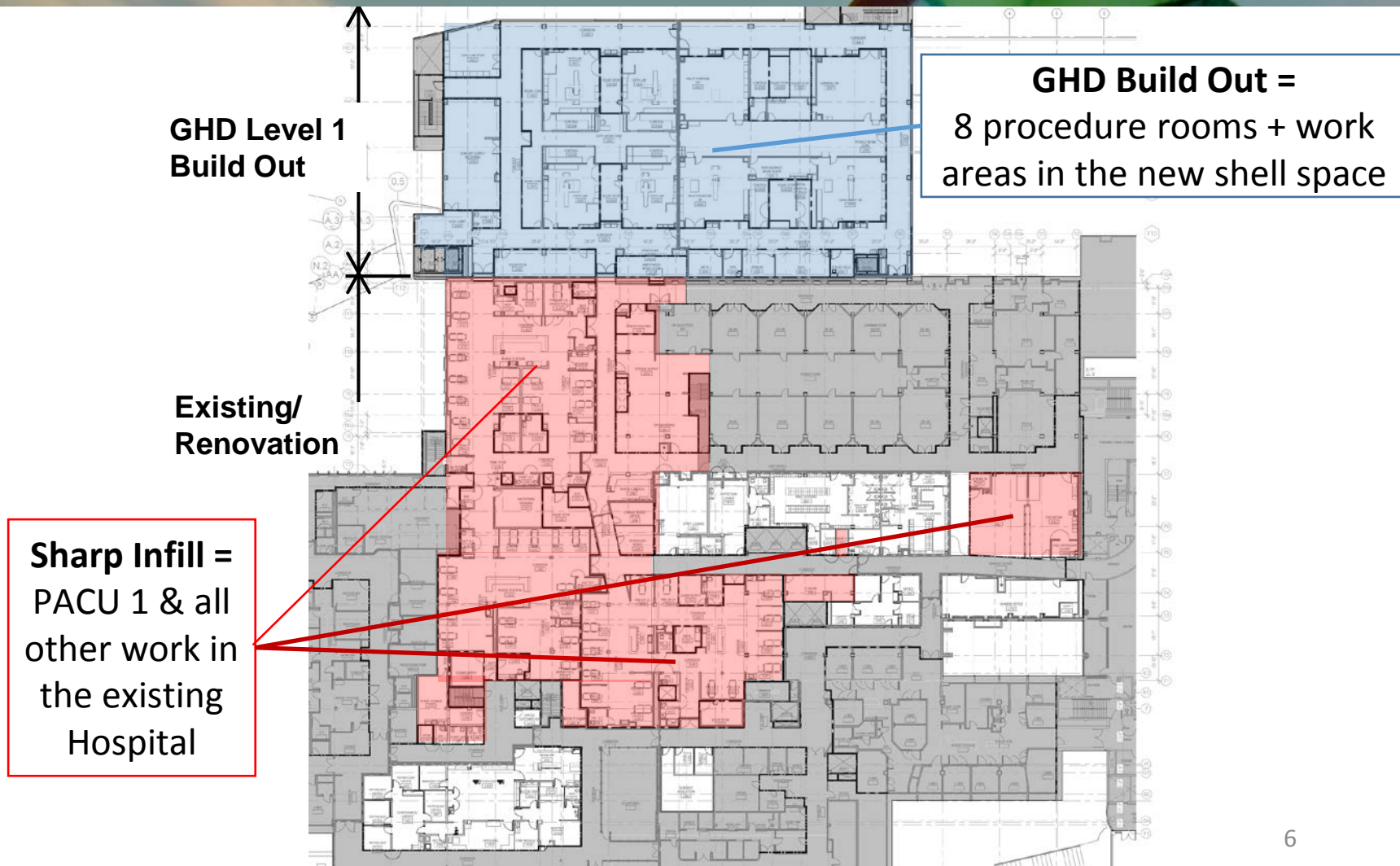

3ii. Surgery Suite Overview Plan

September 2017

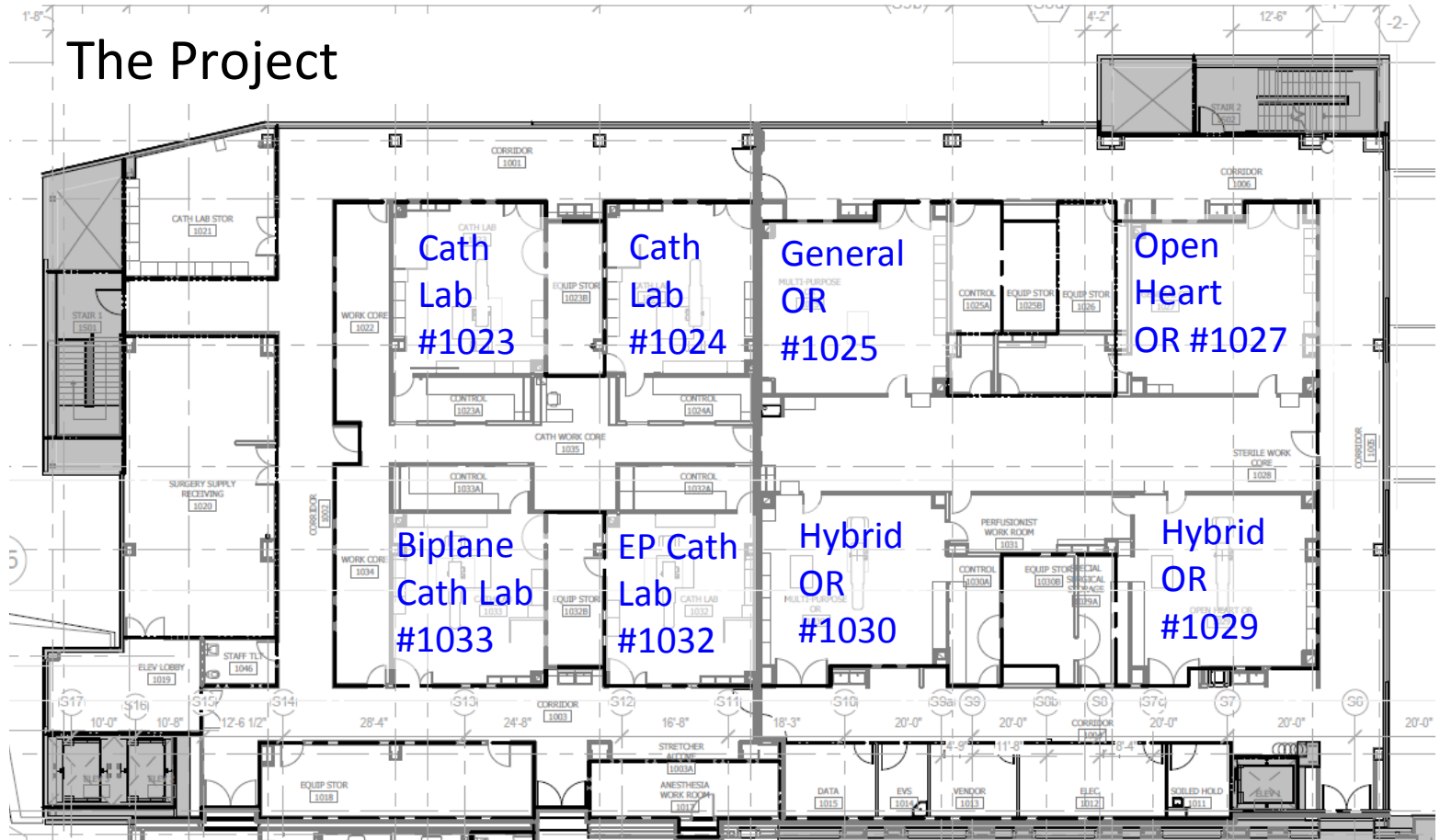

4. Schedule – Prop G

September 2017

We are here

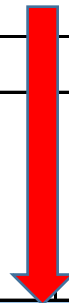

															Updated 9-20-2017									
Prop G Level 1 Surgery Build Out																					Licensing			
																						◆		
	Bid	Award		NTP #1/2	Construction																			
	N	D	J	F	M	A	M	J	J	A	S	O	N	D	J	F	M	A	M	J	J	A	S	
	2016		2017										2018											

4. Schedule: Prop G + Sharp Infill

September 2017

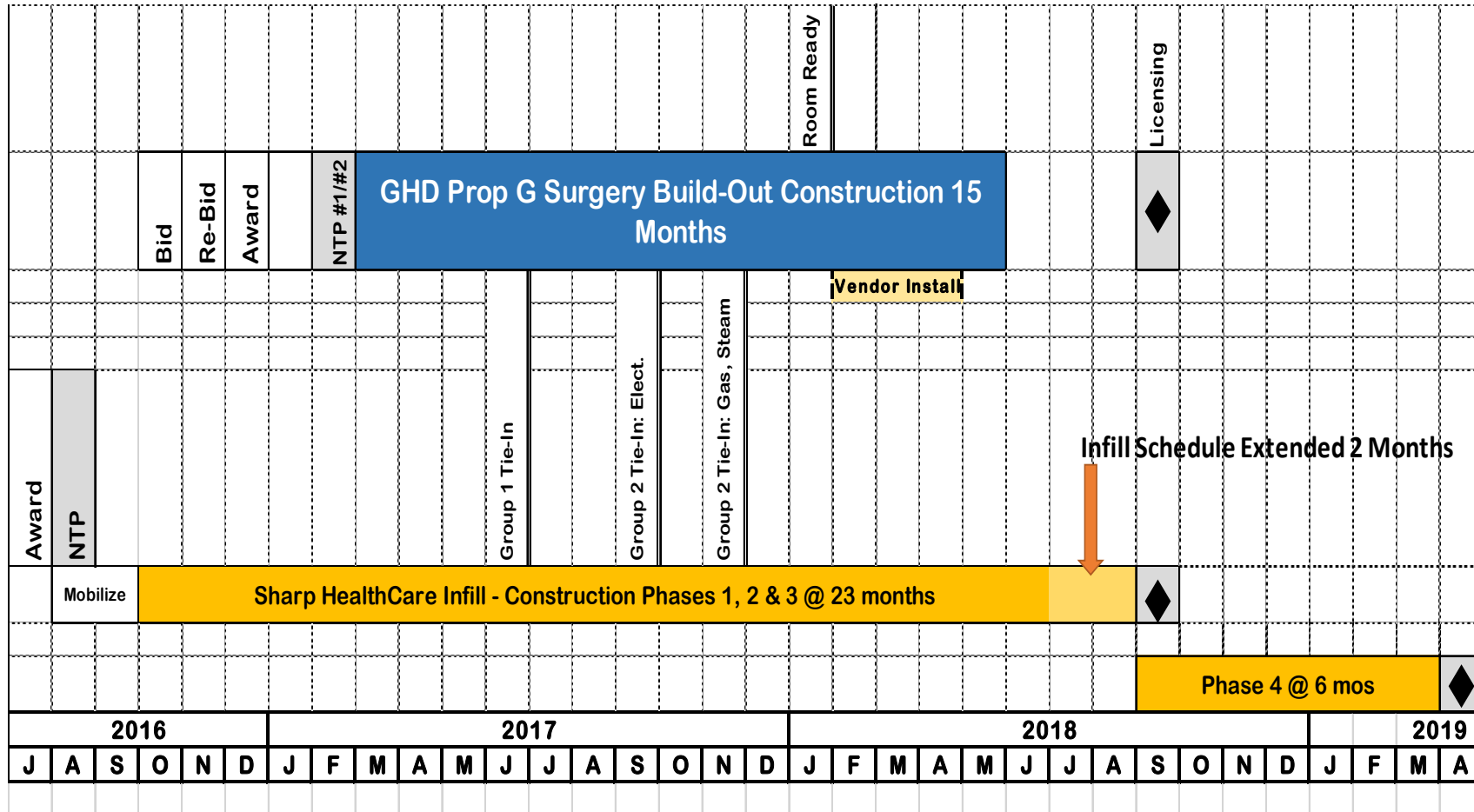

5. Budget

September 2017

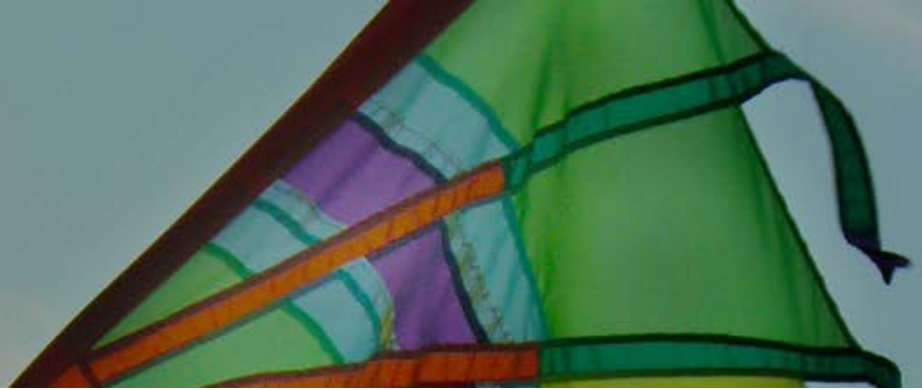

Category	Project Name	Projected Cost At Completion (09/20/17)	Projected Cost At Completion (8/23/2017)
Funds Available	Total Prop G Building Fund (Bond Proceeds, Interest Earned, Grants, Etc.)	\$257,072,011	\$257,072,011
Projects Completed	Central Energy Plant, ED-CCU, Heart & Vascular Bldg, East Tower Renovation, Early Utilities	\$225,996,922	\$225,996,922
	Remaining Prop G Building Funds before Level 1 Surgery	\$31,075,089	\$31,075,089
Projects Under Construction	H&V Level 1 Surgery Floor Buildout	\$29,533,684	\$29,533,684
	Potential Surplus	\$1,541,405	\$1,541,405

6. Snapshot on Sharp HealthCare Infill Project

September 2017

- All Phase 1 construction is complete
- Phase 2 construction underway, including demo in former Level 1 Lab
- Phase 2B demo to start, including Level 1 Sterile Storage and Decontamination
- Schedule delays continue, due to unforeseen conditions



Level 1 Wall, Flooring, Ceiling Demo



Level 1 Ceiling Existing Conditions

7. Looking Ahead

September 2017

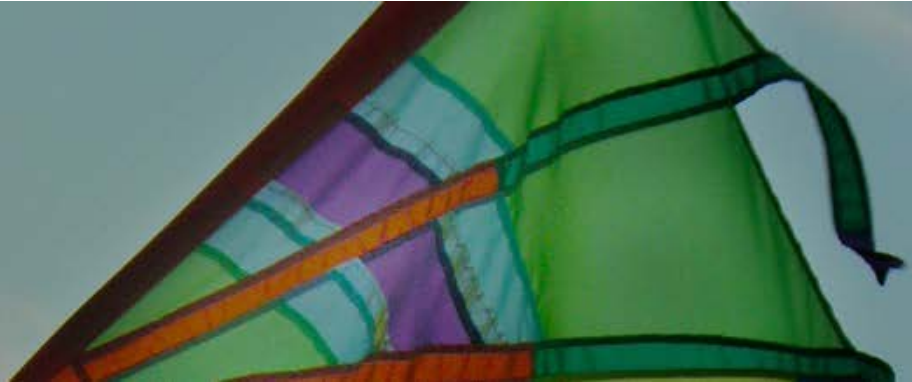

- Continue Installation of Overhead Ductwork, Fire Dampers, Fire Caulking
- Continue rough-in of Overhead Low Voltage/Nurse Call/Fire Alarm
- Group Two Utilities Tie-In with Sharp Infill for electrical, medical gases scheduled for late September; Steam Tie-In postponed to late November to simplify chlorination process
- Helix Waterline potholing, to determine a route for the completed waterline, in progress



Questions?