

# GROSSMONT HEALTHCARE DISTRICT

## PROPOSITION G

## DESIGN & CONSTRUCTION SERVICES



### Monthly Project Construction Report

Contractor: C.W. Driver  
Architect: Stantec

April 2015 (Updated April 22, 2015)

Project : **East Tower Upgrade**

Construction Budget Status	\$	% Complete	Schedule Status	
Award Amount:	\$17,325,000.00		Contract Award Date:	April 3, 2012
Approved CO's:	\$5,743,615.00		% Complete:	119%
Revised Contract:	\$23,068,615.00		Original Completion Date:	Oct. 29, 2014
Invoiced to Date:	\$16,380,495.00	71%	Approved time extension:	0 CD's
<b>Balance</b>	\$6,688,120.00		New Completion Date:	Oct. 29, 2014
Total Forecast Pending CO's:	\$4,041,588.00		Projected Sch. Variance (+/-):	-487 CD's
<b>Forecast Adjusted Budget</b>	\$27,110,203.00		Forecast Completion Date:	March 1, 2016
			% Complete per forecast:	78%

<b>RISK STATUS</b>	Budget:				Schedule:			

Incident Dashboard – East Tower – April 22, 2015						
	Safety - CAL OSHA Incident		Regulatory Compliance / OSHPD (Notice of Non-Compliance)		Infection Control Breach	
	Yes	No	Yes	No	Yes	No
<u>Name of Month</u>						
January	<input type="checkbox"/>	<input checked="" type="checkbox"/>	<input type="checkbox"/>	<input checked="" type="checkbox"/>	<input type="checkbox"/>	<input checked="" type="checkbox"/>
February	<input type="checkbox"/>	<input checked="" type="checkbox"/>	<input type="checkbox"/>	<input checked="" type="checkbox"/>	<input type="checkbox"/>	<input checked="" type="checkbox"/>
March	<input checked="" type="checkbox"/>	<input type="checkbox"/>	<input type="checkbox"/>	<input checked="" type="checkbox"/>	<input type="checkbox"/>	<input checked="" type="checkbox"/>
April	<input type="checkbox"/>	<input checked="" type="checkbox"/>	<input type="checkbox"/>	<input checked="" type="checkbox"/>	<input type="checkbox"/>	<input checked="" type="checkbox"/>
May	<input type="checkbox"/>	<input type="checkbox"/>	<input type="checkbox"/>	<input type="checkbox"/>	<input type="checkbox"/>	<input type="checkbox"/>
<b>Total Project</b>	<b>1</b>	<b>3</b>	<b>0</b>	<b>4</b>	<b>0</b>	<b>4</b>

# GROSSMONT HEALTHCARE DISTRICT

## PROPOSITION G

## DESIGN & CONSTRUCTION SERVICES



### Safety:

- There was 1 safety audit performed by the Smart Safety Group this month.
- CWD's corporate Safety Officer conducted 2 safety walks this month with 0 incidents to report.
- There was an incident on 3/19 where a worker pulled on an existing conduit to help move his rolling scaffolding, which broke loose the conduit coupling and shorted out an emergency power circuit at the Level 5 Nurse Station. The onsite electricians responded immediately and were able to restore emergency power within 1 hour. An incident report is being finalized by CWD. The outage did impact clinical operations, which included the loss of telemetry monitoring and charting computers at the Central Nurse Station and the inability to complete interdisciplinary rounding due to the nursing staff having been placed on bedside monitoring.

### Regulatory Compliance Issue - ADA Parking at the Main Entry:

- Background: In order to clear space for the new Heart and Vascular building, approximately 2 years ago the Hospital relocated the ambulance transport parking stalls from the side entrance to the main entrance of the hospital, restriping the 12 existing ADA parking stalls. The ADA parking stalls were not relocated elsewhere, nor was the modification covered by a permit.

#### Original Condition:



The original condition of the main entrance ADA parking included 12 parking stalls with direct access to the hospital's main entrance.

#### Current Condition:



The original condition was modified in order to accommodate the transport ambulances after those stalls were removed to make way for the new Heart & Vascular building. OSHPD has identified this condition as out of compliance.

# GROSSMONT HEALTHCARE DISTRICT

## PROPOSITION G

## DESIGN & CONSTRUCTION SERVICES



- The OSHPD ACO observed this condition in February 2015, and wrote it up in his Field Visit, stating that “beneficial occupancy may not be granted for Level 4 unless the accessible stalls are returned to their (pre)existing condition, the current condition is accepted by the Office or it can be shown the facility meets the accessible parking requirements under CBC 1129B.1.”.
- Since February, various internal discussions yielded one suggestion, illustrated below as “Option 1”

- **Option 1: Hospitals First proposal to OSHPD, to be re-presented on Monday, April 27th:**

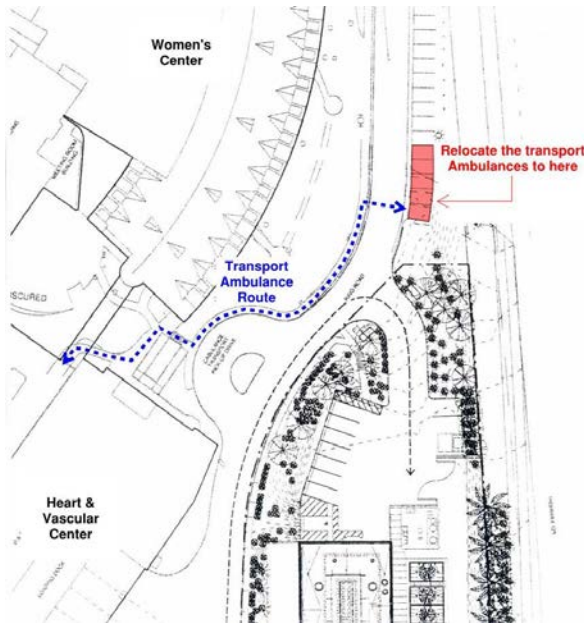

The hospital's first proposal to OSHPD includes converting 5 contractor/vender parking stalls into transport ambulance stalls. The path of travel includes walking around the women's center through the dietary dock and into the hospital behind the Heart & Vascular center.

This proposal was initially rejected by OSHPD due to the lack of the overhead cover at the Transport Ambulance route and the passageway selected being designated as a fire exit only for staff and not intended for patient transportation.

- **Hospital's Second Proposal to OSHPD, to be presented on Monday, April 27th:**

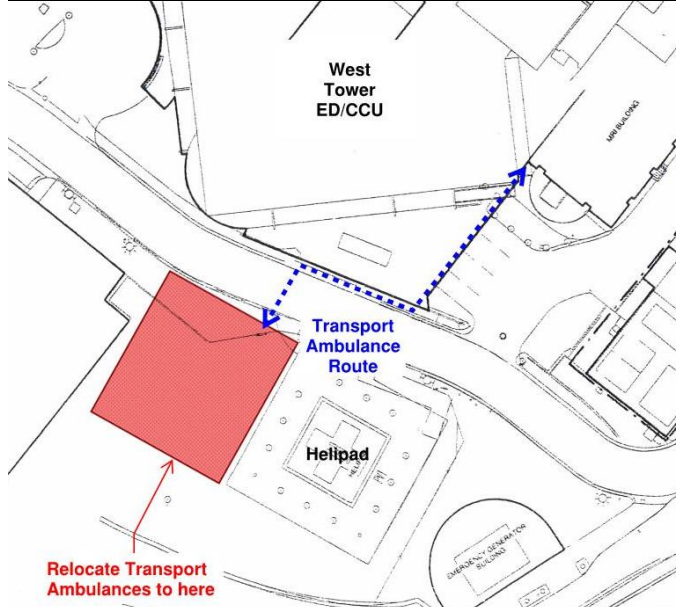

The hospital's second proposal is adjacent to the Helipad. A driveway and parking stalls would be provided for the transport ambulances with a path leading across the road, behind the emergency ambulances into the back of the Emergency Department. The challenges for this proposal include OSHPD and FAA approval to proceed.

# GROSSMONT HEALTHCARE DISTRICT PROPOSITION G

## DESIGN & CONSTRUCTION SERVICES



- **Hospital's Third Proposal to OSHPD, to be presented on Monday, April 27<sup>th</sup>:**



The hospital's third proposal is adjacent to the Physical Rehab Building. It would include a covered parking area, a driveway, parking stalls, and a circle driveway. Access would be directly into and through the Physical Rehab Building to the hospital.

- **All Recommendations Acknowledge:**

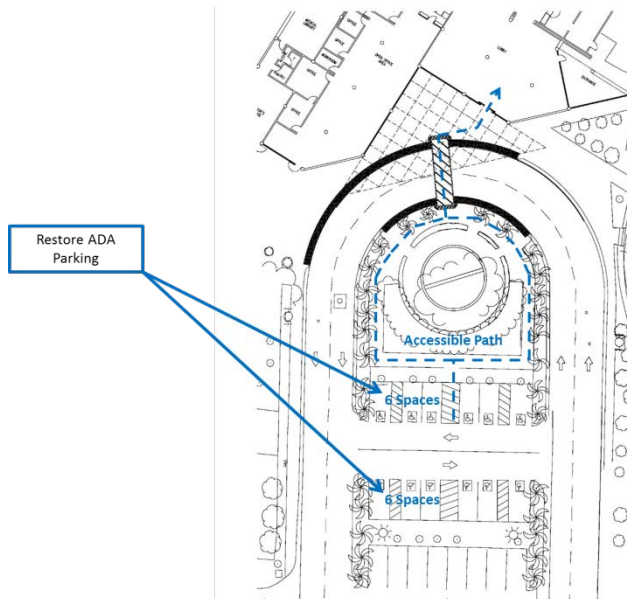

Restoring the ADA Parking area to its original condition, reflecting the condition of the East Tower permitted drawings. To do this requires the relocation of the transport ambulances.

### **Regulatory Compliance Issue – Emergency Oxygen Sensor Control:**

- During the April 15, 2015, OSHPD ACO site visit the ACO advised that he had been informed that a new Emergency Oxygen Sensor Control, serving the relocated Oxygen main line (part of the North Loading Dock project), had not been installed. In response, the ACO included this statement in his 4-15-2015 report: "Note: prior to occupancy for the Level 4 the EOSC non-compliant condition that serves this area and building shall be corrected."

# GROSSMONT HEALTHCARE DISTRICT

## PROPOSITION G

## DESIGN & CONSTRUCTION SERVICES



### Infection Control Issues/Status:

- No reportable issues

### Overall Progress:

- Framing detailing and backing is complete except for two rooms. Drywall installation including tape and mud is ongoing. Installation of final med gas connections to the headwall units is complete. Headwall units are installed in all patient rooms including the panels. The installation of the mural tile in the Non-ADA Patient Toilet Rooms is complete. The 4<sup>th</sup> floor Air Handler and ductwork installation in the roof penthouse is complete. Finished plumbing fixtures, lighting, and electrical are ongoing. Wall coverings, tile and painting are ongoing in all areas. Staff Lockers are installed. Casework and cabinetry installation is ongoing.
- **Miscellaneous:** CW Driver's schedule as of their March 1, 2015, Summary Bar-chart for Level 4 forecasts obtaining Beneficial Occupancy for the floor on June 18, 2015. This week's 4-week Look Ahead, however, forecasts completion on May 22, 2015, and they express confidence in meeting this earlier target date. The schedule for Level 5 indicates beneficial occupancy of that floor on December 23, 2015, with Project Close-out complete on March 1, 2016. This Project Close-out completion date reflects the contract outlined 65 day "close-out" period from the Level 5 Beneficial Occupancy date. DSC is working with CW Driver to allow the "Close-out Period" to be performed concurrent with the completion of Phase 5.
- **Elevator Modernization:** OSHPD final sign off on the elevators is pending the final inspection by the ACO.

### Construction Status Photos:



Central Nurses' Station, drywall installation



Staff Locker Room



New Headwall in Patient Room

### Design Issues:

- There are no current design issues.
- New artwork has been purchased (by Sharp) and pending installation on Levels 2 & 4.

### Construction Issues:

- There are no current critical construction issues.

# GROSSMONT HEALTHCARE DISTRICT

## PROPOSITION G

## DESIGN & CONSTRUCTION SERVICES



### **Corrective Action Plan** *(when applicable):*

- CWD submitted a letter from SDI, the subcontractor responsible for the March 19, 2105, Safety Incident, outlining their actions and submitting the minutes and attendees from a follow-up safety meeting. CWD submitted their cover letter this month, but the Final report from CWD is pending receipt of the incident report from Baker Electric.

**Prepared By:** Kate Herring and Robert Turner

**EAST TOWER UPGRADE**

Date: 04/23/2015

**Cost Status by Budget Category:**

Budget Category	Orig Contract/or Budget	Approved Changes	Current Actuals/Paid	Unspent Commitments	Current Commitments
<b>C.W. Driver</b>	<b>\$ 17,325,000</b>	<b>\$ 5,743,615</b>	<b>\$ 16,380,496</b>	<b>\$ 6,688,119</b>	<b>\$ 23,068,615</b>
Commissioning	53,500	6,000	43,806	15,694	59,500
Hazmat	43,124	37,615	69,180	11,559	80,739
Ptube Budget	581,605		80,988	500,617	581,605
Ptube Contingency	783,067			783,067	783,067
Insurance	282,669		282,669	-	282,669
<b>Construction Subtotal</b>	<b>19,068,965</b>	<b>5,787,230</b>	<b>16,857,139</b>	<b>7,999,056</b>	<b>24,856,195</b>
<b>Equipment Subtotal</b>	<b>-</b>	<b>25,321</b>	<b>11,814</b>	<b>13,507</b>	<b>25,321</b>
<b>Design and Consultant Fees Subtotal</b>	<b>3,700,831</b>	<b>3,210,555</b>	<b>5,807,053</b>	<b>1,104,333</b>	<b>6,911,386</b>
<b>Administrative Costs Subtotal</b>	<b>6,788,010</b>	<b>-</b>	<b>5,136,689</b>	<b>1,651,321</b>	<b>6,788,010</b>
<b>Project Subtotal</b>	<b>\$ 29,557,806</b>	<b>\$ 9,023,106</b>	<b>\$ 27,812,695</b>	<b>\$ 10,768,217</b>	<b>\$ 38,580,912</b>

Contingency-Design and Construction Activity	Beginning	Approved	* Proposed	Remaining	Current
Contingency Bank	\$12,238,697	\$9,023,106	\$3,052,959	\$162,632	\$3,215,591
<b>Totals</b>	<b>\$12,238,697</b>	<b>\$9,023,106</b>	<b>\$3,052,959</b>	<b>\$162,632</b>	<b>\$3,215,591</b>

**Total Project Budget**

**\$41,796,503**

**\$41,796,503**

\* Note: Proposed includes Contractor/Designer proposals and Owner estimates for chgs to Floors 3,4,5 and admin costs to complete.

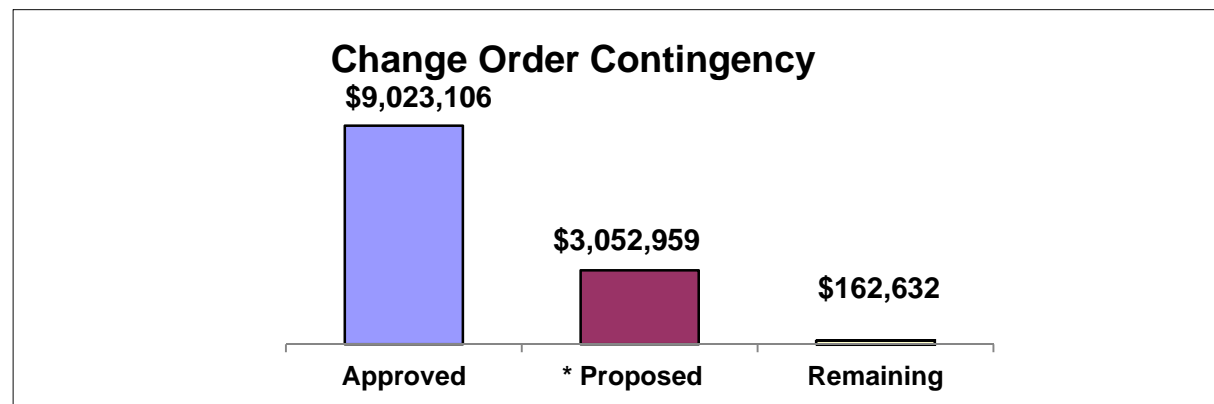

# GROSSMONT HEALTHCARE DISTRICT

## PROPOSITION G

## DESIGN & CONSTRUCTION SERVICES



Contractor: McCarthy  
Architect: KMD

Monthly Project Construction Report  
April 2015 (Updated April 22, 2015)

### Project: Heart and Vascular (B, A, Shell)

Construction Budget Status		% Complete	Schedule Status
Award Amount:	\$26,325,383		Contract Award: January 28, 2013 Executed Contract: April 9, 2013
Approved CO's:	\$3,208,019		% Complete: 100% Original Completion: March 16, 2015
Revised Contract:	\$29,533,402		Approved Time Extensions: 0 CD New Completion: March 16, 2015
Invoiced to Date:	\$23,766,854	81%	Project Scheduled Variance: 215 CD Forecast Completion: October 17, 2015
<b>Balance</b>	\$5,766,548		
Total Forecast Pending CO's:	\$3,719,439		
<b>Forecast Adjusted Budget</b>	\$33,252,841		% Complete per forecast: 82%

<b>RISK STATUS</b>	Budget:				Schedule:			

Incident Dashboard – Heart & Vascular Center – March 25, 2015						
	Safety - CAL OSHA Incident		Regulatory Compliance / OSHPD (Notice of Non-Compliance)		Infection Control Breach	
	Yes	No	Yes	No	Yes	No
<i>Name of Month</i>						
January	<input type="checkbox"/>	<input checked="" type="checkbox"/>	<input type="checkbox"/>	<input checked="" type="checkbox"/>	<input type="checkbox"/>	<input checked="" type="checkbox"/>
February	<input type="checkbox"/>	<input checked="" type="checkbox"/>	<input type="checkbox"/>	<input checked="" type="checkbox"/>	<input type="checkbox"/>	<input checked="" type="checkbox"/>
March	<input checked="" type="checkbox"/>	<input type="checkbox"/>	<input type="checkbox"/>	<input checked="" type="checkbox"/>	<input type="checkbox"/>	<input checked="" type="checkbox"/>
April	<input checked="" type="checkbox"/>	<input checked="" type="checkbox"/>	<input type="checkbox"/>	<input checked="" type="checkbox"/>	<input type="checkbox"/>	<input checked="" type="checkbox"/>
<b>Total Project</b>	<b>2</b>	<b>3</b>	<b>0</b>	<b>4</b>	<b>0</b>	<b>4</b>

# GROSSMONT HEALTHCARE DISTRICT

## PROPOSITION G

## DESIGN & CONSTRUCTION SERVICES



### Safety:

- There have been no reportable incidents in April.

### Regulatory Compliance:

- There have been no reportable incidents in April.

### Infection Control Issues/Status:

- Infection control barriers are in place and in compliance.

### Overall Progress:

- West side of H&V Expansion Joint work has begun on the East Tower
- Helix and domestic water lines have been installed
- Majority of rooftop equipment and ducts have been installed and is getting ready to start with functional testing
- Level B interior build-out ongoing with paint prime and first coat, overhead T-grid hangers installed
- Level A interior build-out ongoing, walls are being closed-up, MEP overhead has been signed off and is wrapping up punch items. Ceiling grid is beginning to be installed. Painting is underway at level A
- Level 1 interior build-out ongoing, walls are framed and utility being rough-in
- Penthouse level equipment installation is ongoing
- Exterior cement plaster systems punch list to begin soon

### Status Photos:



Level 1 Expansion Joint on East Tower



Level A Electrical Room

# GROSSMONT HEALTHCARE DISTRICT PROPOSITION G

## DESIGN & CONSTRUCTION SERVICES

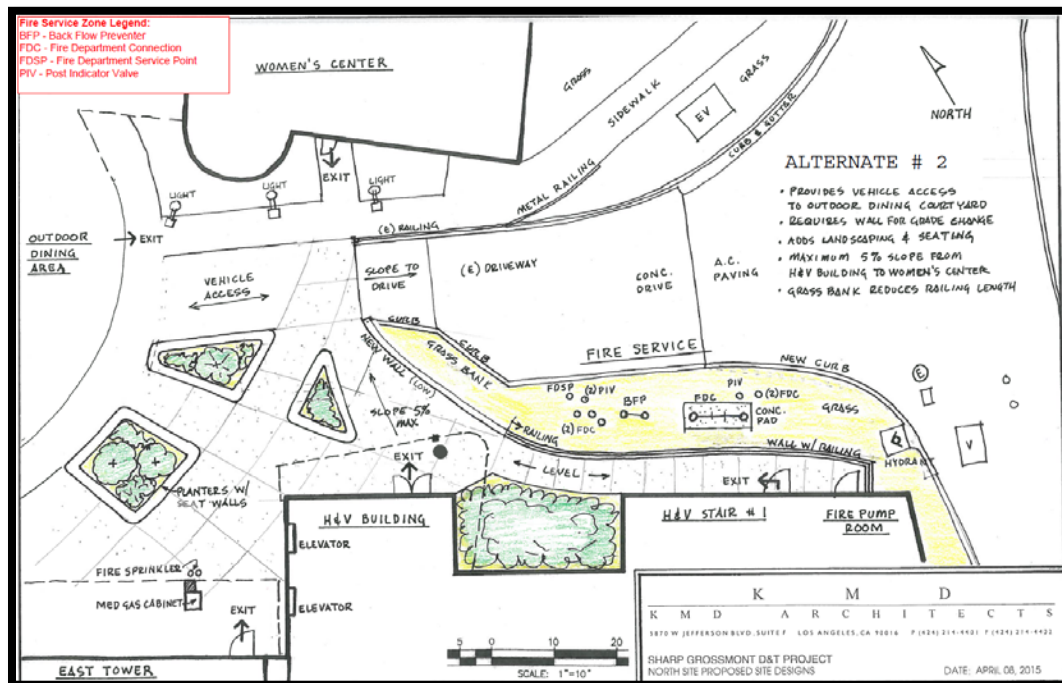

**H&V North Site Plan**

### Design Issues:

- North site loading dock utilities and re-design to accommodate for the H&V exiting ramp installation, and additional design to enhance the area.
- The oxygen supply to the East Tower including pressure monitoring and emergency service is under-going redesign by the H&V project requiring coordination between the closed Early Utilities Package and Interim Dietary Loading Dock projects, as well as the ongoing Central Energy Plant project.
- Revised exiting is underway with a ramp at the south loading dock area.
- Composite survey information is in the process of assembly to reflect record drawings for utilities and other site components.
- Programing for card readers and cameras is to start in 2 months.

### Construction Issues:

- The utility trellis is underway but restricting the development of the south East corner.
- The Helix water line installation has failed with a bacterial test (BacT) at the meter.
- Windows failed the water test at the sill joint. Additional testing is ongoing with the waterproofing consultant ABB and the AOR,
- Roof drain pipes are to be relocated behind the columns as shown on the KMD documents.

# GROSSMONT HEALTHCARE DISTRICT

## PROPOSITION G

## DESIGN & CONSTRUCTION SERVICES



### Corrective Action Plan:

- Design:
  - The team is re-designing the north and south docks to accommodate for the existing conditions, to create the exiting requirement for the H&V building
- Construction:
  - Sharp Design & Construction Services is investigating contingency options for potential workarounds for future Central Energy Plant utilities to be provided to the Heart & Vascular Center to prevent further impact to the start-up and commissioning of the HVAC, Power and Plumbing systems in the H&V.
  - Helix plans to replace the lateral (10' in length) and then perform the BacT test again prior to connecting to the H&V building.
  - Team is discussing the removal of the window to investigate the sill leak source. Additional corrective measure will be taken but not until more water tests have been conducted.
  - Colors for painting the laboratory walls have been finalized

Prepared By: Gary Kiebel / Kevin Herr / Vicki Townsend

HEART AND VASCULAR BUILDING

Date: 04/23/2015

Cost Status by Budget Category:

Budget Category	Orig Contract/or Budget	Approved Changes	Current Actuals/Paid	Unspent Commitments	Current Commitments
McCarthy Contract	\$26,325,383	\$3,208,019	23,766,854	\$5,766,548	29,533,402
Sharp Const Reimb		(294,313)	(294,313)	-	(294,313)
Commissioning	96,740	-	25,609	71,131	96,740
Hazmat	8,410	86,824	90,684	4,550	95,234
Ptube Budget	697,395		520,922	176,473	697,395
Ptube Contingency	270,957		-	270,957	270,957
<b>Construction Subtotal</b>	<b>27,398,885</b>	<b>3,000,530</b>	<b>24,109,756</b>	<b>6,018,702</b>	<b>30,399,415</b>
<b>Equipment Subtotal</b>	<b>909,775</b>		<b>-</b>	<b>909,775</b>	<b>909,775</b>
<b>Design and Consultant Fees Subtotal</b>	<b>8,588,211</b>	<b>4,317,524</b>	<b>11,886,396</b>	<b>1,019,339</b>	<b>12,905,735</b>
<b>Administrative Costs Subtotal</b>	<b>9,752,654</b>		<b>8,732,134</b>	<b>1,020,520</b>	<b>9,752,654</b>
<b>Project Subtotal</b>	<b>\$46,649,525</b>	<b>\$7,318,054</b>	<b>\$44,728,286</b>	<b>\$8,968,336</b>	<b>\$53,967,579</b>

Contingency-Design and Construction Activity	Beginning	Approved	* Proposed	Remaining	Current
Contingency Bank	\$12,364,066	\$7,318,054	\$4,399,383	\$646,629	\$5,046,012
<b>Totals</b>	<b>\$12,364,066</b>	<b>\$7,318,054</b>	<b>\$4,399,383</b>	<b>\$646,629</b>	<b>\$5,046,012</b>

**Total Project Budget**

**\$59,013,591**

**\$59,013,591**

\* Proposed includes Contractor and Designer PCOs and Owner estimates for projected costs, and adm costs to complete.

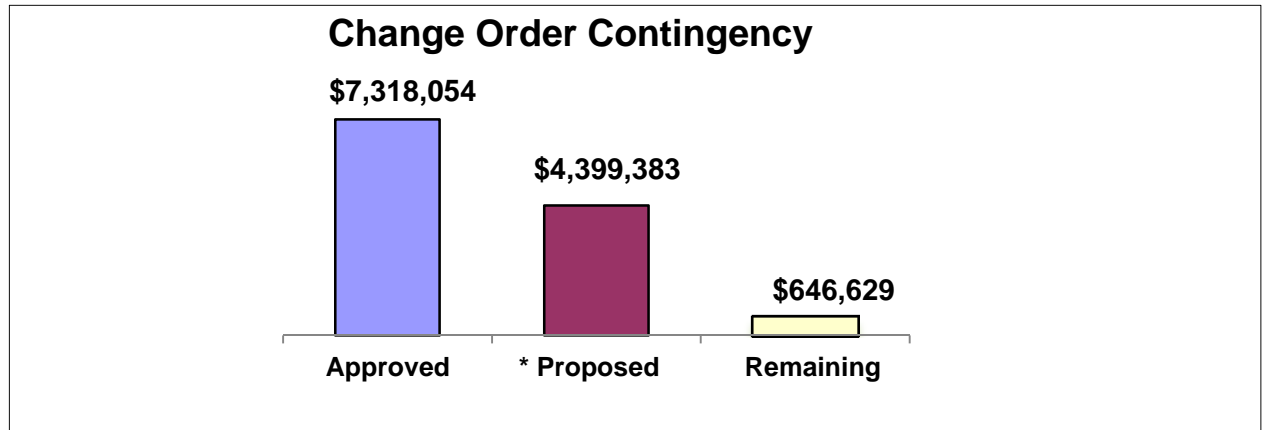

Level 1 Buildout - DESIGN PHASE

Date: 04/23/2015

Cost Status by Budget Category:

Budget Category	Orig Contract/or Budget	Approved Changes	Current Actuals/Paid	Unspent Commitments	Current Commitments
<b>Current Construction Budget</b>	<b>\$10,856,368</b>	<b>\$0</b>	<b>0</b>	<b>\$10,856,368</b>	<b>10,856,368</b>
Other	\$0		0		0
Commissioning	\$20,000	\$0	0	\$20,000	20,000
<b>Construction Subtotal</b>	<b>\$10,876,368</b>	<b>\$0</b>	<b>\$0</b>	<b>\$10,876,368</b>	<b>\$10,876,368</b>
<b>Equipment Subtotal</b>	<b>\$8,328,628</b>		<b>0</b>	<b>\$8,328,628</b>	<b>8,328,628</b>
<b>Design and Consultant Fees Subtotal</b>	<b>\$1,888,631</b>	<b>\$757,520</b>	<b>1,882,572</b>	<b>\$763,579</b>	<b>2,646,151</b>
<b>Administrative Costs Subtotal</b>	<b>\$3,812,021</b>	<b>\$0</b>	<b>1,048,151</b>	<b>\$2,763,870</b>	<b>3,812,021</b>
<b>Project Subtotal</b>	<b>\$24,905,648</b>	<b>\$757,520</b>	<b>\$2,930,723</b>	<b>\$22,732,445</b>	<b>\$25,663,168</b>

Contingency-Design and Construction Activity	Beginning	Approved	* Proposed	Remaining	Current
* Contingency Bank	\$4,248,277	\$757,520	\$6,989,064	(\$3,498,307)	\$3,490,757
<b>Totals</b>	<b>\$4,248,277</b>	<b>\$757,520</b>	<b>\$6,989,064</b>	<b>(\$3,498,307)</b>	<b>\$3,490,757</b>

**Total Project Budget**

**\$29,153,925**

**\$29,153,925**

\* Proposed includes revised project budgets for construction per Cummings Aug 2014 report, AE proposed changes and projected adm cost to complete to 10/2017.

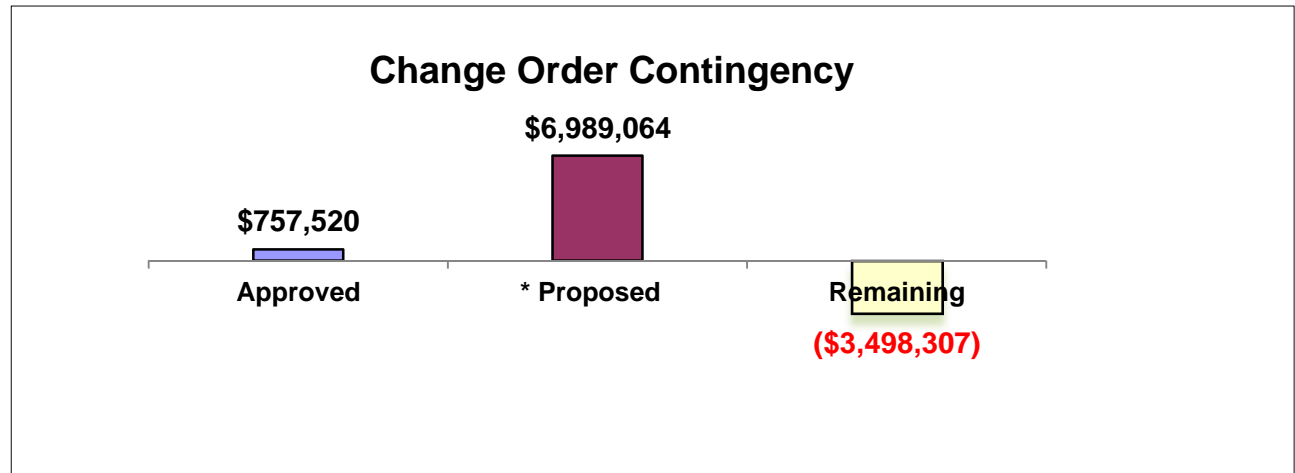

# GROSSMONT HEALTHCARE DISTRICT

## PROPOSITION G

## DESIGN & CONSTRUCTION SERVICES



Contractor: McCarthy

Architect: Syska Hennessy

Monthly Project Construction Report

April 2015 (Updated April 22, 2015)

Project: **Central Energy Plant/Co-Gen**

CEP Construction Budget Status	\$	% Complete	Schedule Status	
Award Amount:	\$ 26,066,942		Contract Award Date :	July 27, 2012
Approved CO's:	\$ 4,677,993		Percent Complete:	105%
Revised Contract:	\$ 30,744,935		Original Completion Date:	March 2, 2015
Invoiced to Date:	\$ 27,910,129	91%	Approved Time Extension:	0 Days
<b>Balance</b>	\$ 2,834,806		New Completion Date:	March 2, 2015
Total Forecast Pending CO's	\$ 9,143,508		Projected Sch.Variance(+/-):	-172
<b>Forecast Adjusted Budget</b>	\$ 39,888,443		Forecast Completion Date:	February 12, 2016
			% Complete per forecast	77%

COGEN Construction Budget Status	\$	% Complete	Schedule Status	
Award Amount:	\$ 6,907,991		Contract Award Date :	July 27, 2012
Approved CO's:	\$ 807,295		Percent Complete:	105%
Revised Contract:	\$ 7,715,286		Original Completion Date:	March 2, 2015
Invoiced to Date:	\$ 7,013,743	91%	Approved Time Extension:	0 Days
<b>Balance</b>	\$ 701,543		New Completion Date:	March 2, 2015
Total Forecast Pending CO's:	\$ 556,105		Projected Sch.Variance(+/-):	-347
<b>Forecast Adjusted Budget</b>	\$ 8,271,391		Forecast Completion Date:	February 12, 2016
			% Complete per forecast	77%

### RISK STATUS

Budget:



Schedule:



# GROSSMONT HEALTHCARE DISTRICT

## PROPOSITION G

## DESIGN & CONSTRUCTION SERVICES



Incident Dashboard – <i>Central Energy Plant – April 22, 2015</i>						
	Safety - CAL OSHA Incident		Regulatory Compliance / OSHPD (Notice of Non-Compliance)		Infection Control Breach	
	Yes	No	Yes	No	Yes	No
<i>Name of Month</i>						
January	<input type="checkbox"/>	<input checked="" type="checkbox"/>	<input type="checkbox"/>	<input checked="" type="checkbox"/>	<input type="checkbox"/>	<input checked="" type="checkbox"/>
February	<input type="checkbox"/>	<input checked="" type="checkbox"/>	<input type="checkbox"/>	<input checked="" type="checkbox"/>	<input type="checkbox"/>	<input checked="" type="checkbox"/>
March	<input checked="" type="checkbox"/>	<input type="checkbox"/>	<input type="checkbox"/>	<input checked="" type="checkbox"/>	<input type="checkbox"/>	<input checked="" type="checkbox"/>
April	<input checked="" type="checkbox"/>	<input type="checkbox"/>	<input type="checkbox"/>	<input checked="" type="checkbox"/>	<input type="checkbox"/>	<input checked="" type="checkbox"/>
<b>Total Project</b>	<b>0</b>	<b>4</b>	<b>0</b>	<b>3</b>	<b>0</b>	<b>3</b>

### Safety:

- A worker slipped and fell resulting in a bruised thigh.

### Regulatory Compliance:

- There have been no reportable incidents in April.

### Infection Control Issues/Status:

- Infection control barriers are in place and in compliance.

### Overall Progress

#### Interior:

- The equipment is still being connected to their respective electrical system and/or piping in anticipation of powering on the building electrical system.
- The last Interior wall framing modifications are being completed.
- Alarm Panels are being installed.
- Lighting fixtures are being installed.
- An electrical switchgear bucket reconfiguration is being done with spiced wires.

#### Exterior:

- Piping and electrical conduits in the Utility Tunnel to the H&V Vault are installed.
- Finishes around the Trash Enclosure at the North end of the project are being done.
- The precast utility tunnel lids are precast ready for deliver.
- Asphalt paving at the North end is complete.
- Work in the H&V vault to the CUP is starting.

# GROSSMONT HEALTHCARE DISTRICT

## PROPOSITION G

## DESIGN & CONSTRUCTION SERVICES



### Existing Central Utility Plant (CUP);

- Utility Trellis footings are poured.
- Rule 21 switchgear structural pad is poured.

### .COGEN Status:

- CA ISO agreements and components (Meters) are being finalized.
- The NGR is being installed.

### Construction Status Photos:



*Stucco above utility tunnel*



*Utility Tunnel being fitted out with piping*



*North site trash enclosure bio-swale*

### Design Issues:

- The new design relocating the Oxygen Tank Farm has been OSHPD approved and needs final City of La Mesa sewer easement vacation.
- Emergency Generator enclosures seismic calculations have had another OSHPD review and minor modifications are to be done.
- Phasing plans for the commissioning of the CEP are being developed formally for purposes of presentation to OSHPD and for use by Engineering to plan the utility cutovers.
- Turbine load bank testing plans are being vetted and scheduled.
- The code complying wall removal behind HVSB is being reviewed by OSHPD.
- The design team needs a revision of some piping in the existing CUP to account for thermal stresses.

### Construction Issues:

- Water intrusion is still be an issue at a flashing clad column and a thru the wall vent.
- The anchor bolts holes for the HRSG, Vent and Platform hit slab reinforcing, thus requiring an design analysis and fix.
- Shot pins into a gusset plate need to be repaired in a method acceptable to the SER and OSHPD.
- The contractor has not installed the specified rigid conduit is some locations and is proposing a solution.
- The contractor has not installed some hot dipped galvanized unistrut in some locations and is replacing the material.
- The contractor has not installed some ductwork support per approved plans and is seeking alternates.

# GROSSMONT HEALTHCARE DISTRICT

## PROPOSITION G

## DESIGN & CONSTRUCTION SERVICES



### **Infection Control Issues/Status:**

- None (freestanding building outside main hospital)

### **Safety:**

- None

### **Corrective Action Plan *(when applicable)*:**

- None

**Prepared By:** John Serdar

Central Energy Plant

Date: 4/23/2015

Cost Status by Budget Category:

Budget Category	Orig Contract/or Budget	Approved Changes	Current Actuals/Paid	Unspent Commitments	Current Commitments
<b>McCarthy Contract</b>	<b>\$26,066,942</b>	<b>\$4,677,993</b>	<b>27,910,129</b>	<b>\$2,834,806</b>	<b>30,744,935</b>
Commissioning	122,000	-	95,485	26,515	122,000
HazMat Abatement	-	25,000	-	25,000	25,000
<b>Construction Subtotal</b>	<b>26,188,942</b>	<b>4,702,993</b>	<b>28,005,614</b>	<b>2,886,321</b>	<b>30,891,935</b>
<b>Equipment Subtotal</b>	<b>-</b>	<b>-</b>	<b>-</b>	<b>-</b>	<b>-</b>
<b>Design and Consultant Fees Subtotal</b>	<b>3,847,500</b>	<b>3,746,055</b>	<b>5,506,743</b>	<b>2,086,812</b>	<b>7,593,555</b>
<b>Administrative Costs Subtotal</b>	<b>8,354,706</b>	<b>-</b>	<b>7,561,176</b>	<b>793,530</b>	<b>8,354,706</b>
<b>Project Subtotal</b>	<b>\$38,391,148</b>	<b>\$8,449,048</b>	<b>\$41,073,533</b>	<b>\$5,766,663</b>	<b>\$46,840,196</b>

Contingency-Design and Construction Activity	Beginning	Approved	* Proposed	Remaining	Current
Contingency Bank	\$8,796,305	\$8,449,048	\$8,513,025	(\$8,165,768)	\$347,257
<b>Totals</b>	<b>\$8,796,305</b>	<b>\$8,449,048</b>	<b>\$8,513,025</b>	<b>(\$8,165,768)</b>	<b>\$347,257</b>

**Total Project Budget**

**\$47,187,453**

**\$47,187,453**

\* Proposed includes Contractor, Designer proposed changes, and Owner estimates for projected construction, delays and admin costs to complete.

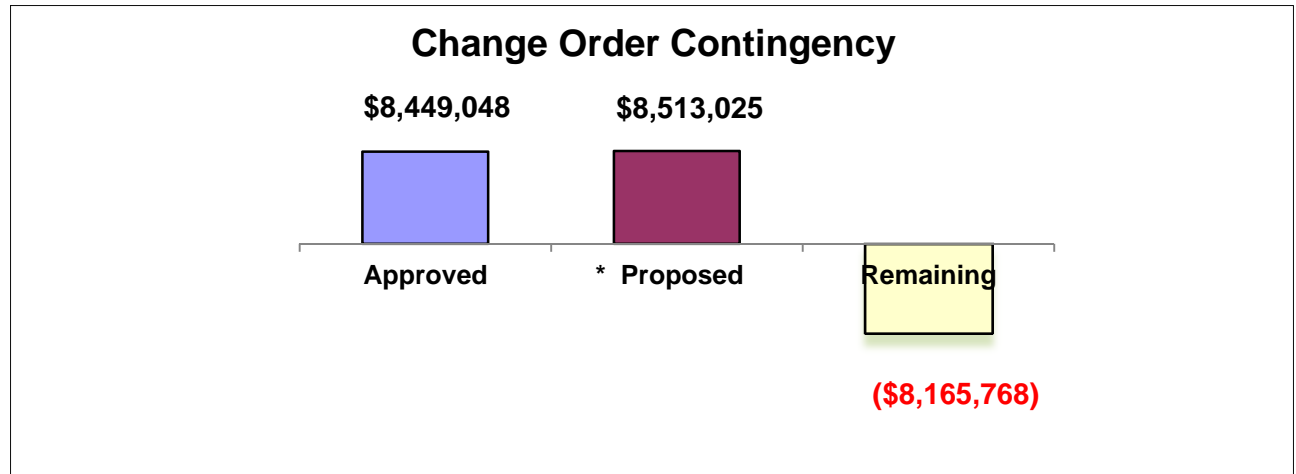

Co-Generation-RBS Funded (Not Prop G)

4/23/2015

Cost Status by Budget Category:

Budget Category	Orig Contract/or Budget	Approved Changes	Current Actuals/Paid	Unspent Commitments	Current Commitments
<b>McCarthy Contract</b>	<b>\$6,907,991</b>	<b>\$807,295</b>	<b>7,013,743</b>	<b>\$701,543</b>	<b>7,715,286</b>
Commissioning	\$50,000	\$0	0	\$50,000	50,000
Solar-Cogen Unit	\$4,642,786	\$176,466	4,704,166	\$115,086	4,819,252
<b>Construction Subtotal</b>	<b>\$11,600,777</b>	<b>\$983,761</b>	<b>11,717,909</b>	<b>\$866,629</b>	<b>12,584,538</b>
<b>Equipment Subtotal</b>	<b>\$0</b>	<b>0</b>	<b>0</b>	<b>\$0</b>	<b>0</b>
<b>Design and Consultant Fees Subtotal</b>	<b>\$0</b>	<b>\$599,677</b>	<b>172,129</b>	<b>\$427,548</b>	<b>599,677</b>
<b>Administrative Costs Subtotal</b>	<b>\$1,003,638</b>	<b>\$0</b>	<b>534,558</b>	<b>\$469,080</b>	<b>1,003,638</b>
<b>Project Subtotal</b>	<b>\$12,604,415</b>	<b>\$1,583,438</b>	<b>\$12,424,596</b>	<b>\$1,763,257</b>	<b>\$14,187,853</b>

Contingency-Design and Construction Activity	Beginning	Approved	* Proposed	Remaining	Current
Contingency Bank	\$5,395,585	\$1,583,438	\$590,106	\$3,222,041	\$3,812,147
<b>Totals</b>	<b>\$5,395,585</b>	<b>\$1,583,438</b>	<b>\$590,106</b>	<b>\$3,222,041</b>	<b>\$3,812,147</b>

**Total Project Budget**

**\$18,000,000**

**\$18,000,000**

\* Proposed includes GC and AE proposals, Owner estimated projected const costs, and admin costs to complete.

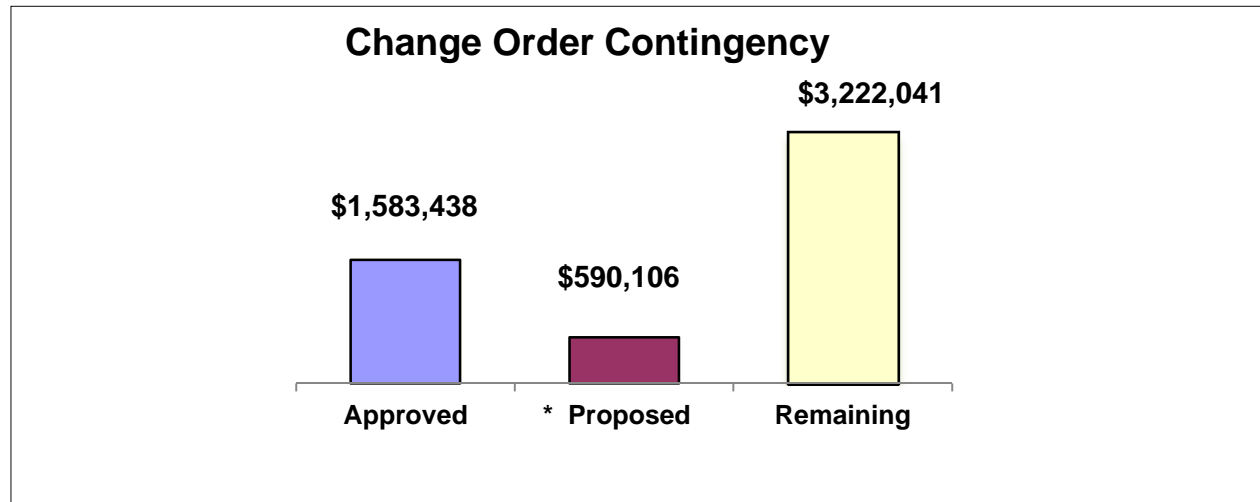

South Load Dock/Level B Seismic  
Cost Status by Budget Category:

Date: 04/23/2015

Budget Category	Orig Contract/or Budget	Approved Changes	Current Actuals/Paid	Unspent Commitments	Current Commitments
C.W. Driver	\$5,666,285	\$3,576,381	9,242,666	\$0	9,242,666
Repairs by Others-JW Smart and Sharp	\$79,683	\$0	76,569	\$3,114	79,683
<b>Construction Subtotal</b>	<b>\$5,745,968</b>	<b>\$3,576,381</b>	<b>9,319,235</b>	<b>\$3,114</b>	<b>9,322,349</b>
<b>Equipment Subtotal</b>	<b>\$0</b>	<b>0</b>	<b>0</b>	<b>\$0</b>	<b>0</b>
<b>Design and Consultant Fees Subtotal</b>	<b>\$30,968</b>	<b>\$1,256,115</b>	<b>1,236,821</b>	<b>\$50,262</b>	<b>1,287,083</b>
<b>Administrative Costs Subtotal</b>	<b>\$1,410,937</b>	<b>\$0</b>	<b>1,399,570</b>	<b>\$11,367</b>	<b>1,410,937</b>
<b>Project Subtotal</b>	<b>\$7,187,873</b>	<b>\$4,832,496</b>	<b>\$11,955,626</b>	<b>\$64,743</b>	<b>\$12,020,369</b>

Contingency-Design and Construction Activity	Beginning	Approved	* Proposed	Remaining	Current
Contingency Bank	\$4,949,621	\$4,832,496	\$0	\$117,125	\$117,125
<b>Totals</b>	<b>\$4,949,621</b>	<b>\$4,832,496</b>	<b>\$0</b>	<b>\$117,125</b>	<b>\$117,125</b>

**Total Project Budget**

**\$12,137,494**

**\$12,137,494**

Contractor is paid in full. Project is in progress for final closeout.

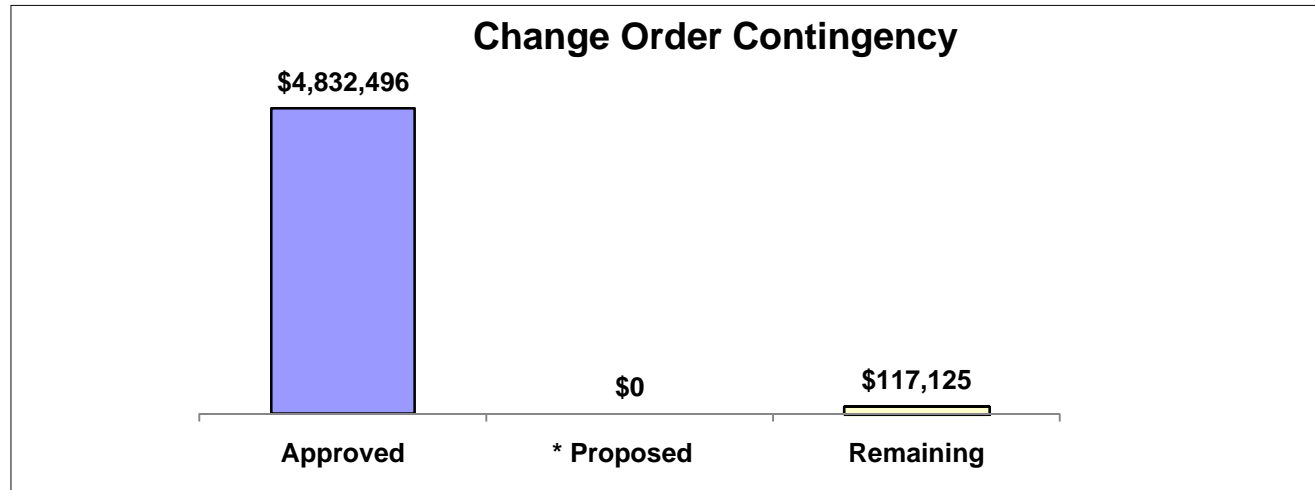

EARLY UTILITIES

4/23/2015

Cost Status by Budget Category:

Budget Category	Orig Contract/or Budget	Approved Changes	Current Actuals/Paid	Unspent Commitments	Current Commitments
<b>Swinerton</b>	<b>\$7,400,000</b>	<b>\$3,065,137</b>	<b>10,465,137</b>	<b>\$0</b>	<b>10,465,137</b>
Repairs by othes-Hawthorne and HWD	726,244	48,053	774,297	-	774,297
Credit back from Sharp	-	(167,723)	(167,723)	-	-167,723
Hazmat		113,415	113,415	-	113,415
<b>Construction Subtotal</b>	<b>8,126,244</b>	<b>3,058,882</b>	<b>11,185,126</b>	<b>-</b>	<b>11,185,126</b>
<b>Equipment Subtotal</b>	<b>-</b>	<b>-</b>	<b>-</b>	<b>-</b>	<b>0</b>
<b>Design and Consultant Fees Subtotal</b>	<b>16,810</b>	<b>829,015</b>	<b>773,942</b>	<b>71,883</b>	<b>845,825</b>
<b>* Administrative Costs Subtotal</b>	<b>1,447,970</b>	<b>-</b>	<b>1,327,801</b>	<b>120,169</b>	<b>1,447,970</b>
<b>Project Subtotal</b>	<b>\$9,591,024</b>	<b>\$3,887,897</b>	<b>\$13,286,869</b>	<b>\$192,052</b>	<b>\$13,478,921</b>

Contingency-Design and Construction Activity	Beginning	Approved	Proposed	Remaining	Current
Contingency Bank	\$4,503,479	\$3,887,897	\$0	\$615,582	\$615,582
<b>Totals</b>	<b>\$4,503,479</b>	<b>\$3,887,897</b>	<b>\$0</b>	<b>\$615,582</b>	<b>\$615,582</b>

**Total Project Budget**

**\$14,094,503**

**\$14,094,503**

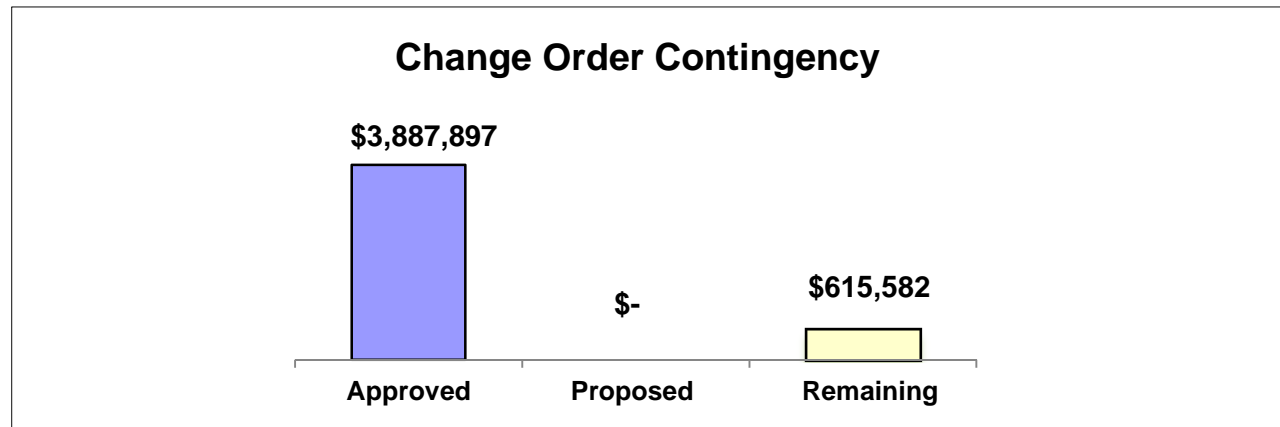

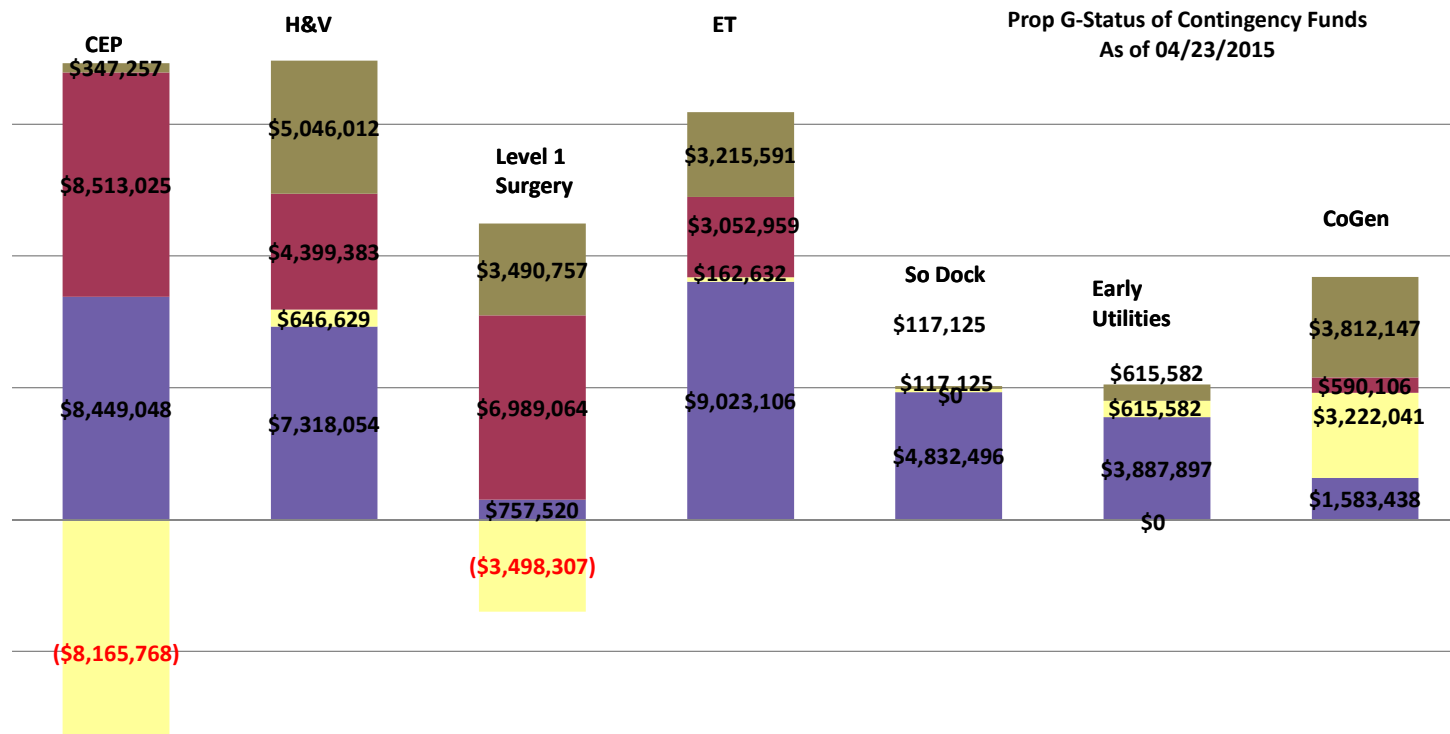

	CEP	H&V	Level 1	E Tower	SLD	EUP	CoGen (Non Prop G funded)
■ Current Bank	\$347,257	\$5,046,012	\$3,490,757	\$3,215,591	\$117,125	\$615,582	\$3,812,147
■ Proposed	\$8,513,025	\$4,399,383	\$6,989,064	\$3,052,959	\$0	\$0	\$590,106
■ Remaining	(\$8,165,768)	\$646,629	(\$3,498,307)	\$162,632	\$117,125	\$615,582	\$3,222,041
■ Approved	\$8,449,048	\$7,318,054	\$757,520	\$9,023,106	\$4,832,496	\$3,887,897	\$1,583,438