

Grossmont Healthcare District

July 2018 Prop G Board Report



Reflection:

“All great achievements require time.”

Maya Angelou

Overview



1. Regulatory Compliance
2. H&V Level 1 Surgery Build Out
3. Plan
4. Schedule
5. Budget
6. Snapshot on Sharp HealthCare Infill Project
7. Looking Ahead

1. Regulatory Compliance

Project	Safety Event	Infection Control Breach	Notice of Non-Compliance
Level 1 Surgery Build Out	1	0	0

As of 7-25-18 **fourteen** issues had been escalated to NNC's, and **all** have been resolved.

2. H&V Level 1 Surgery Build Out

- Medical equipment installation is complete throughout
- AE formal punch list is complete throughout; items are being addressed
- Schedule delays: 65 days approved to date. 13 day delay incurred due to Philips medical equipment installation, plus 7 delay days due to completion issues (possibly non-compensable)
- Test & Balance of HVAC system is complete
- Commissioning of the medical equipment systems is complete
- Commissioning of the electrical, HVAC systems continues
- 4th Floor East Tower Handrails complete
- Helix Waterline Replacement work started 6-18-18 and stopped after a safety incident on 7-2-18

3i. Surgery Suite Overview Plan:

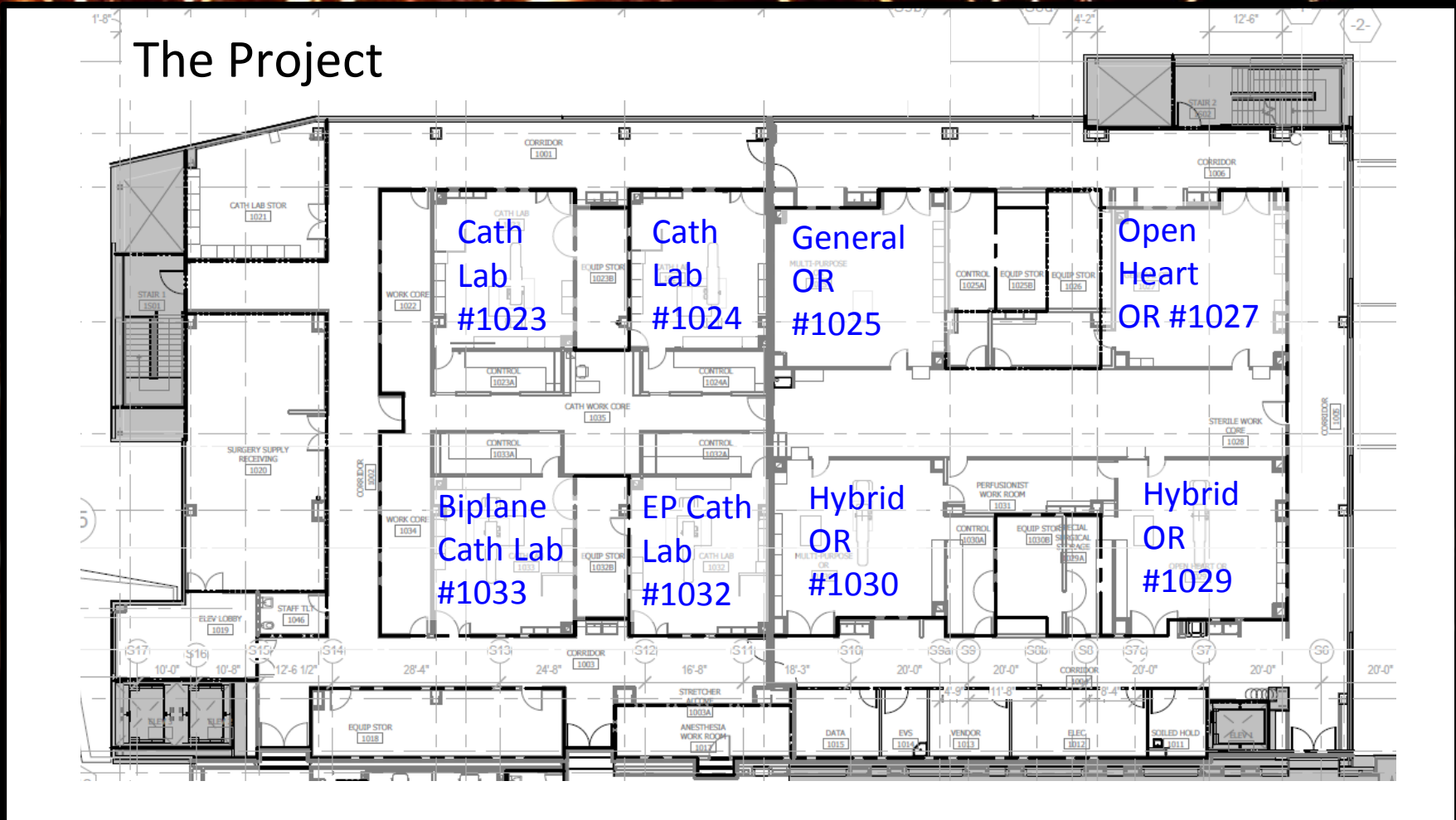

The installation of medical equipment is complete in all rooms

4. Schedule: Prop G + Sharp Infill

Once OSHPD issues a Certificate of Occupancy, the Hospital will apply for licensing from CDPH, requesting utilization of the Build Out ORs and Cath Labs before Infill Phase 3 is completed

Schedule Overview of GHD & Sharp Work

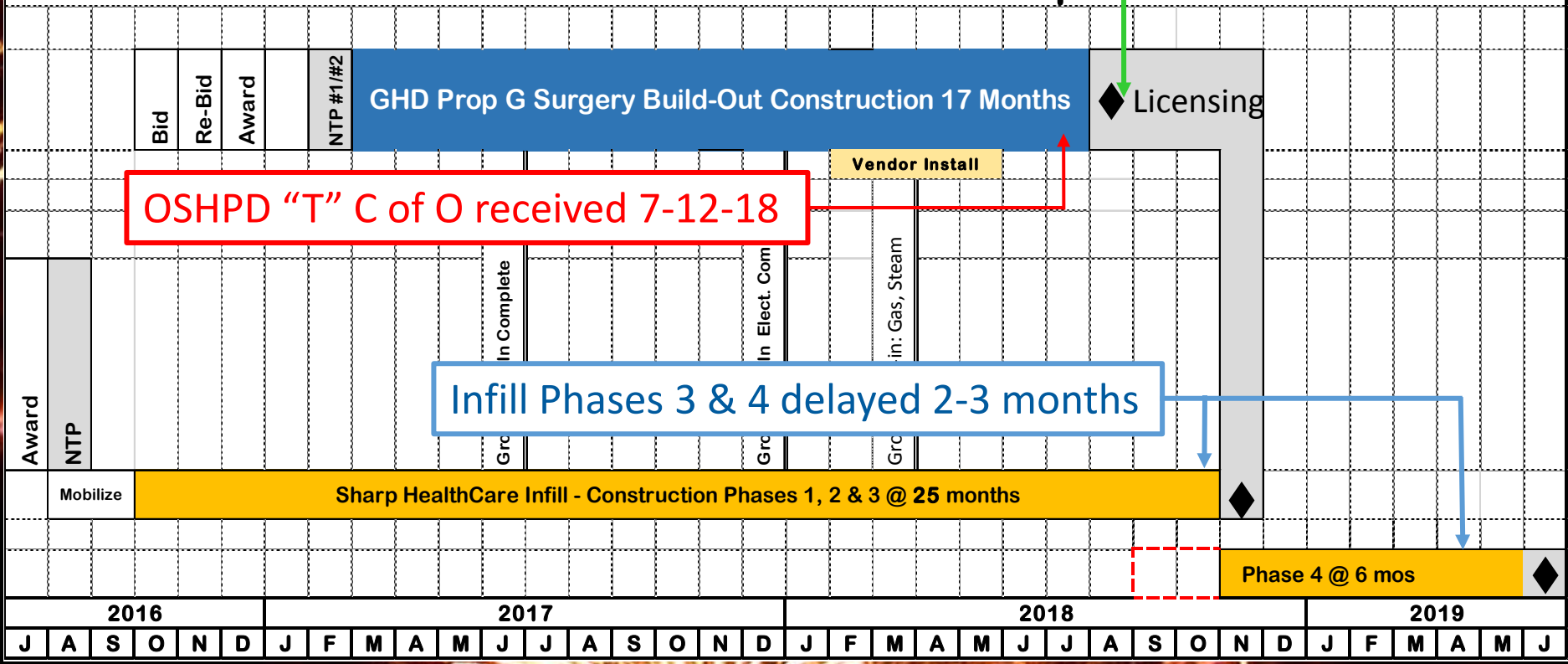

5. Budget

Category	Project Name	Projected Cost At Completion (07/25/18)	Projected Cost At Completion (06/21/18)	Footnotes
Current Funds Available	Total Prop G Building Fund (Bond and Settlement Proceeds, Interest Earned, Grants, Etc.)	\$ 261,198,796	\$ 260,982,543	1
Projects Completed	Central Energy Plant, ED-CCU, Heart & Vascular Bldg, East Tower Renovation, Early Utilities	\$ 225,834,531	\$ 225,834,531	
	Remaining Prop G Building Funds	\$ 35,364,265	\$ 35,148,012	
Projects Under Construction	H&V Level 1 Surgery Floor Buildout	\$ 34,194,527	\$ 34,194,527	
	Forecast Potential Surplus	\$ 1,169,738	\$ 953,485	

Footnote:

1-Current funds Available includes interest/dividend earnings received for FY18 of \$216,253

6. Snapshot on Sharp HealthCare Infill Project



- Ongoing utilities shutdown & safe-off; Level 1 construction continues
- Construction demolition of the former Surgery Prep-A & Prep-B spaces is ongoing
- Expansion breakthrough work to H&V Level 1 on schedule
- Experience Center begins
- H&V north site work started & in progress



Demolition of former Surgery Prep-B Space



Demolition of former Surgery Prep-B Space



7. Looking Ahead



- Complete Functional Performance Testing of essential systems and 3rd party commissioning of HVAC, and electrical systems
- Resolve action plan for the Helix Waterline replacement
- Complete installation of software to support medical equipment in all ORs and Cath Labs, projected into August
- Issue Notice of Completion



Questions?